

HANGING SCREEN INSTALL GUIDE

Mumble
By Design

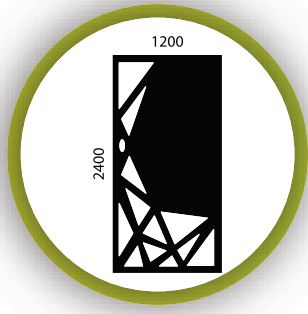

COMPONENTS



Hanging Screen

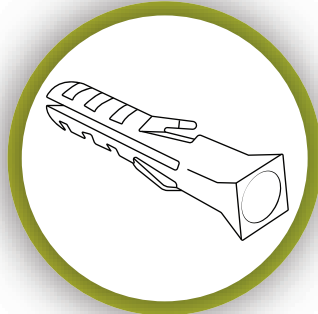

4 x ceiling/floor anchors appropriate for substrate.
(Not all options supplied)

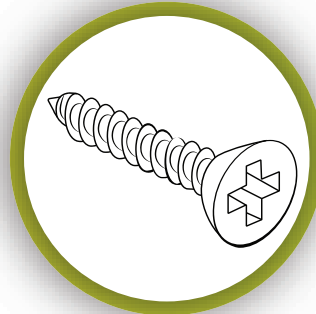

4 x screws appropriate for substrate.
(Not all options supplied)

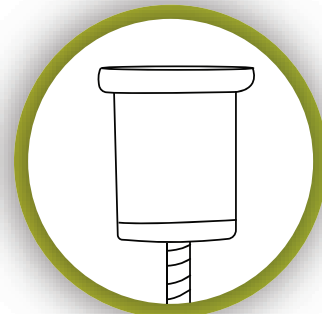

4 x ceiling/floor attachments

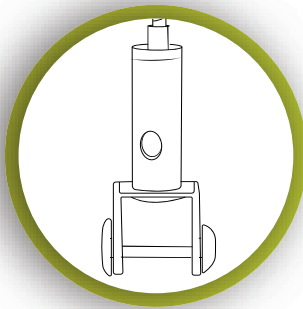

4 x screen attachments

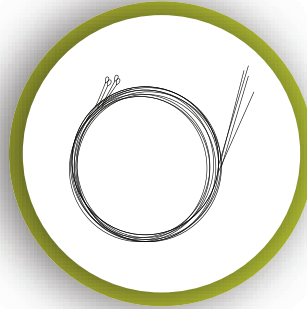

4 x 1m wires

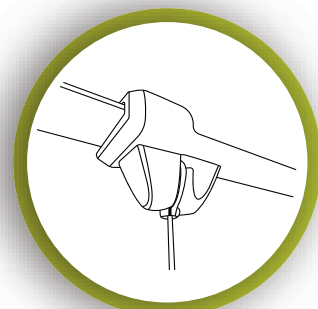

2 x Grid hung twist clips
(if specified)

WHAT IS REQUIRED FOR INSTALLATION



2 People



Ladder

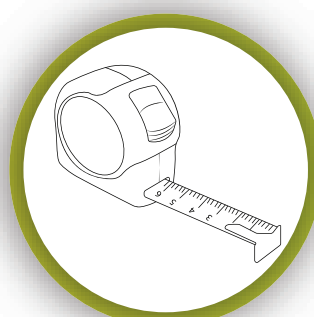

Measuring Tape

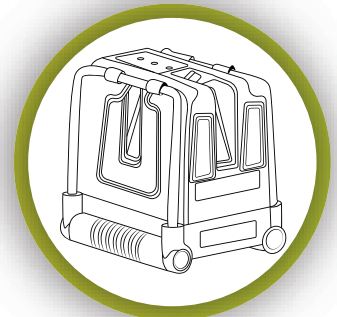

Laser level

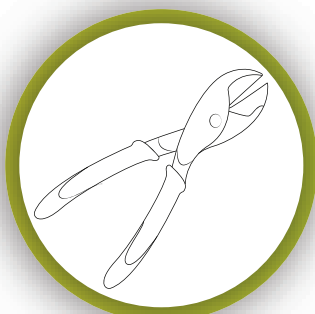

Wire snippers

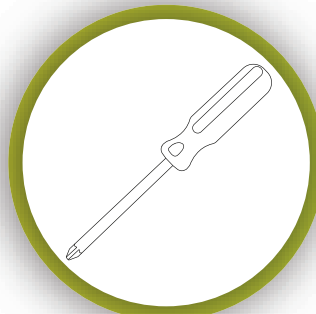

Phillips Head Screwdriver

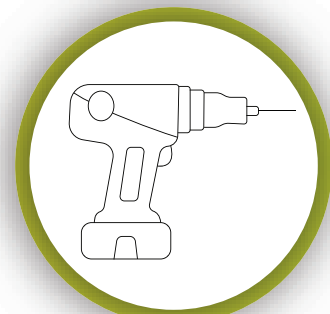

Drill with Phillips head

HOW TO INSTALL

Before installing be sure you have all components and tools required.

Also be sure the product is not damaged in anyway.

SUSPENSION OPTIONS

Screw and Anchor

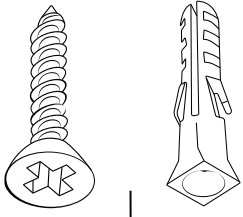

Grid ceiling twist clip

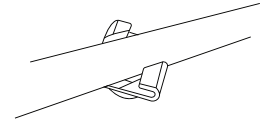

For screw/anchor option skip to screw and anchor after step 1



For grid ceiling twist clip option continue to grid ceiling twist clip after step 1

Step 1

Mark out a gap of 900mm width on the ceiling and floor.

If you have requested top fixings only, only mark out the ceiling

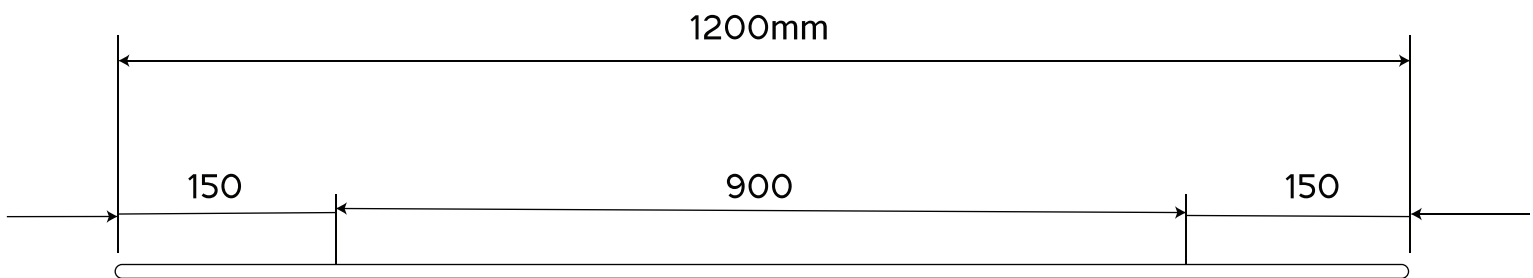

Install tips: Measure twice install once. Make sure the holes are inline and the correct distance.

Using a Laser can assist infinding thestraight line however it is not necessary.

GRID CEILING TWIST CLIP

Step 2

Once measured, twist the twist clip onto the grid as shown below

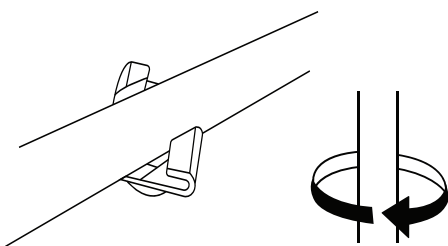

Step 3

Thread the cable through the Twist clip as shown below.

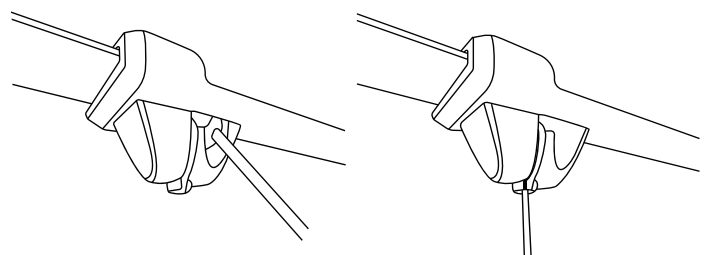

If connecting to the floor, please skip to step 6.

The same method of installing the ceiling attachment is replicated for the floor attachment.

For screw and anchor option please see next page.

SCREW AND ANCHOR

Step 2 Unscrew the ceiling/floor mount provided.



Step 3

Fix the top half of the mount into the ceiling and floor.

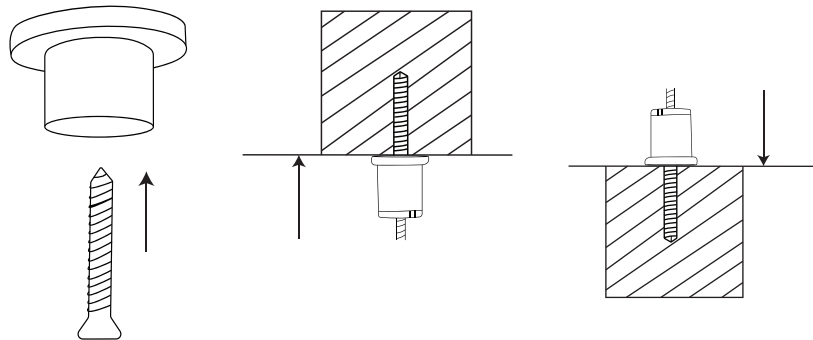

Step 4

Thread the cable through the bottom half of ceiling mount.
Be sure the knob is on the inside of the mount.

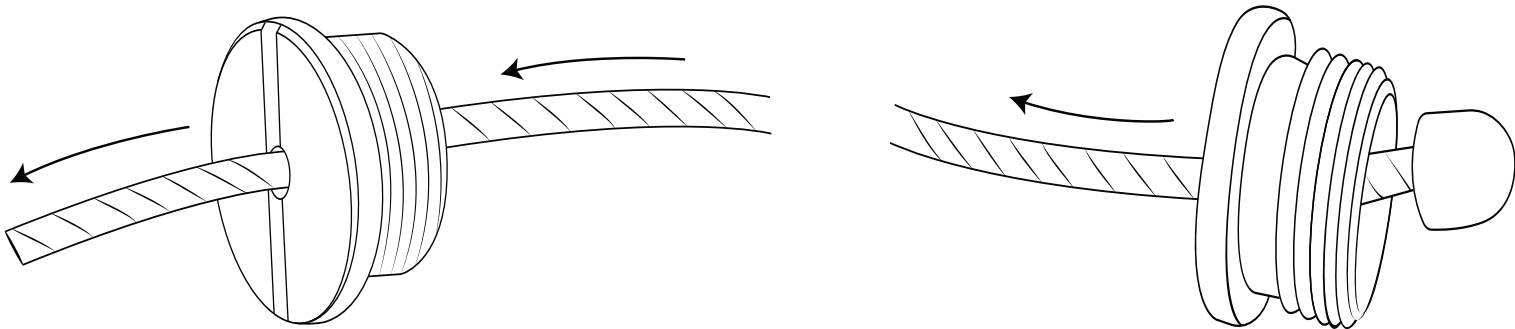

Step 5

Screw bottom half of ceiling mount (with cable threaded through) into the top half fixed into the ceiling. Repeat for the floor mount.

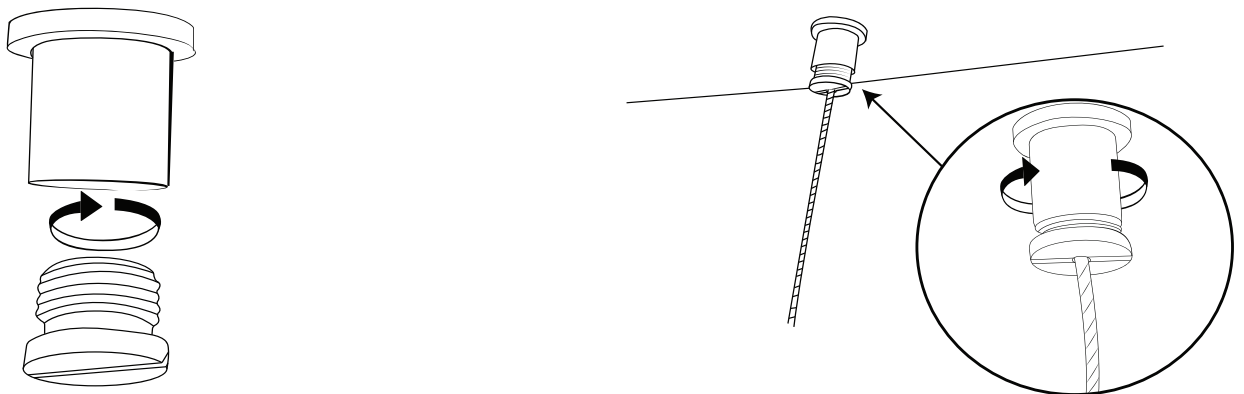

Step 6

Use the Phillips head screwdriver to unscrew the panel bracket.

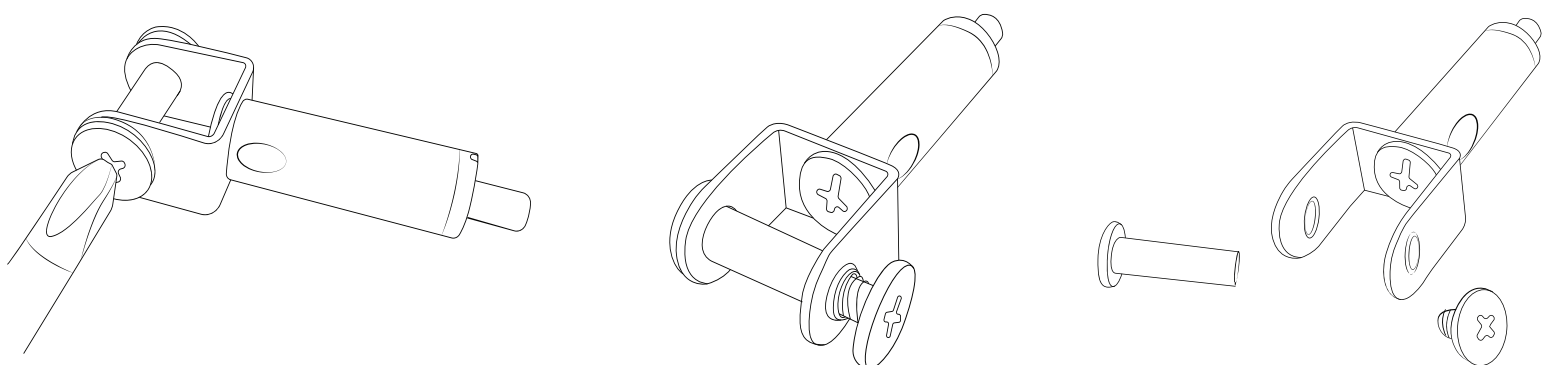

Step 7

Align the screen attachment with pre-cut holes on panel. Insert the screw on the bracket through the hole, and screw back together. (Make sure the screw and holes for wiring are on the same side)

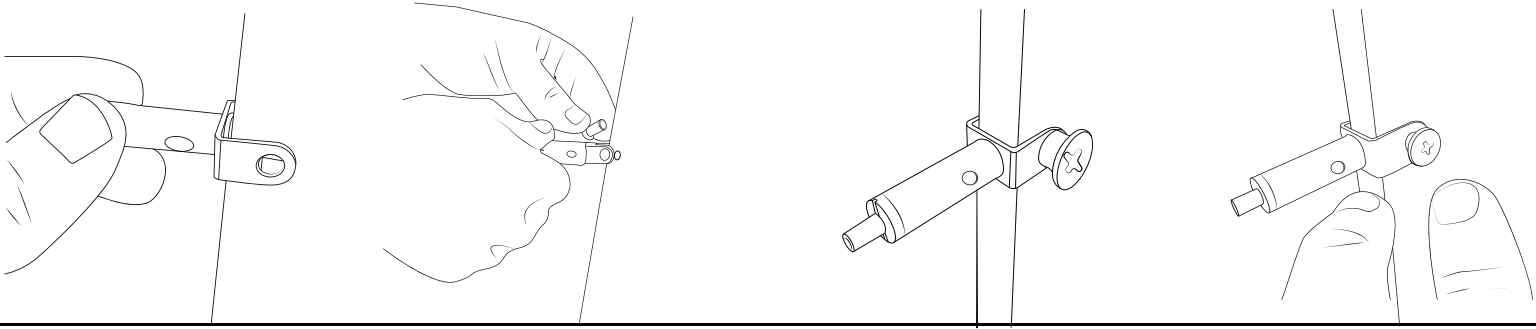

Step 8

Use 2 people. One lift the panel as the other threads the cable through the top of the screen attachment until you reach the desired height.



Step 9

To release the cable or adjust height, push down on the spring lever on the top of the screen attachment and pull the cable out.

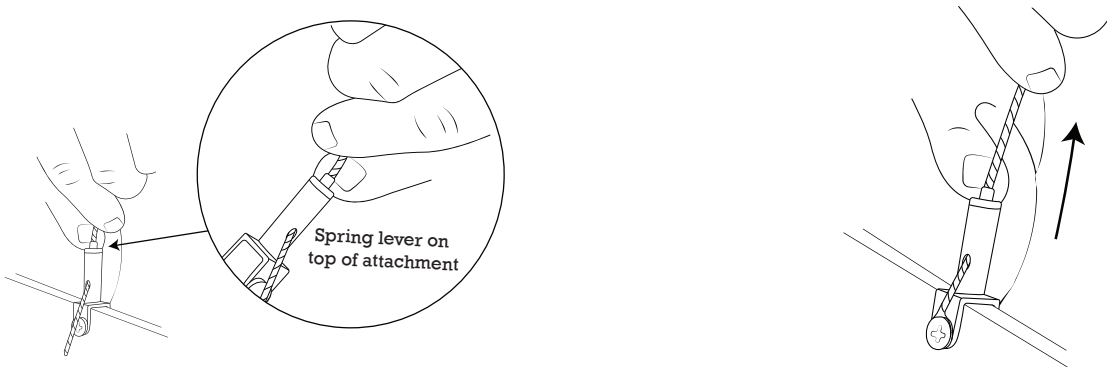

Step 10

Once in the correct height, using wire cutters, trim the excess cable off. Beware after trimming, the cable may have sharp ends

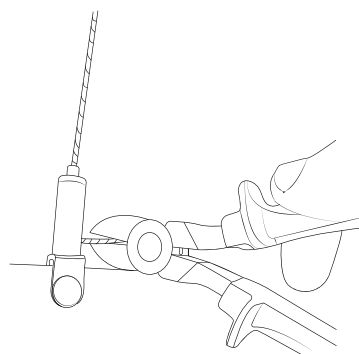

Protect from direct sunlight.

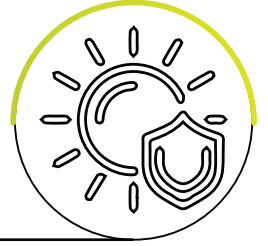

Vacuum regularly using low suction and smooth attachment.



Remove spills immediately using damp, clean cloth.

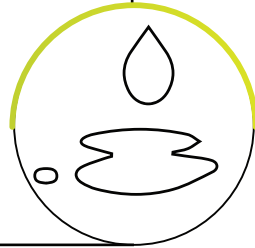

Carpet & fabric cleaners can be used.
Always test in an inconspicuous area first.

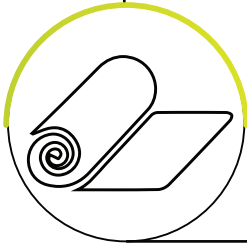

Gently scrape soil or mop liquid from the surface of the fabric,
do not scrub.

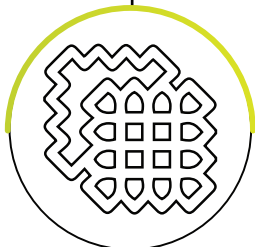

Avoid concentrated rubbing.



Avoid excessive amounts of water or other cleaning materials.

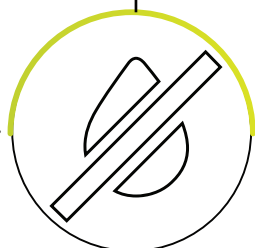

If the product is likely to be subject to excessive moisture,
Ensure adequate ventilation.

